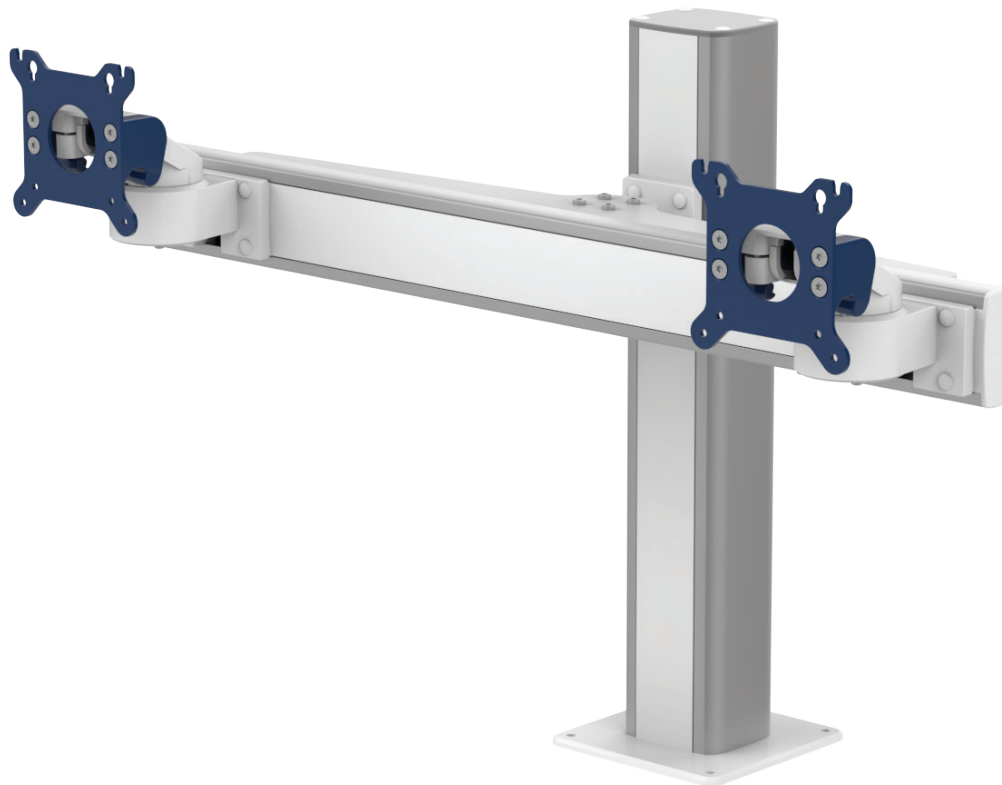

Dual display column mount - side by side

MD

Configuration shown below consists of:

Part No.

Horizontal channel with two flush mounts

A-D908G-4S.**CD**

Monitor adaption: VESA 75/100 with tilt / swivel function

Maximum monitor weight: 16 kg / 35.3 lbs on each side

Adapter for vertical wall channel

Table and floor column

T-CTP-60.w_500

height 500 mm/ 19.7"

Dual display column mount - side by side

Technical data

FRONT VIEW

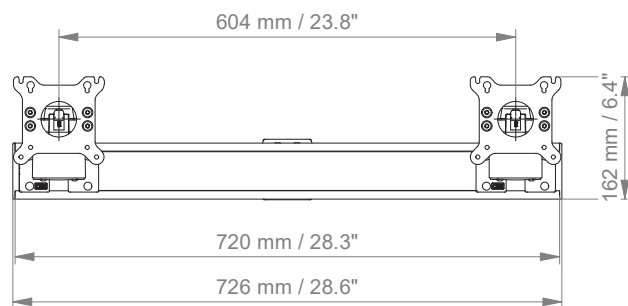

TOP VIEW

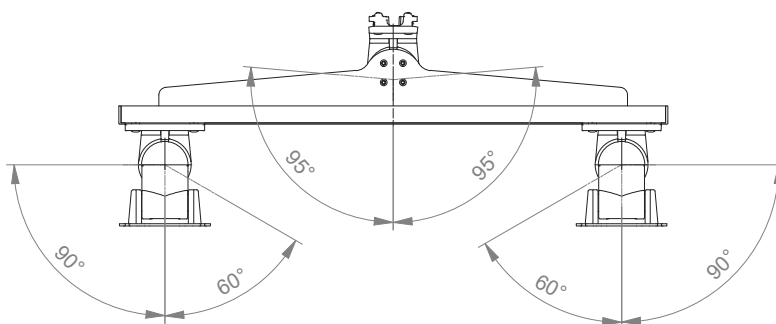

SIDE VIEW

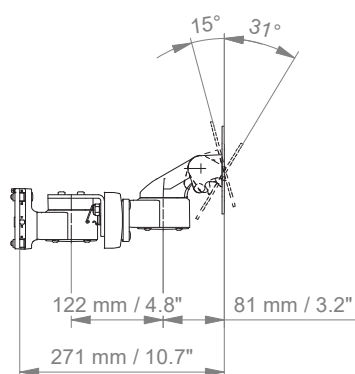

How to create part numbers

Part numbers can be easily created by following the steps below:

Please replace the letters in **green** with the part no. code as per your requirements.

1. Choose the colour requested for decorative parts (**C**):

gr	=	RAL 7024 (graphite grey)
bl	=	RAL 5013 (cobalt blue)

2. Choose the colour requested for the aluminium die-cast parts (**D**):

1	=	RAL 9016 (traffic white)
2	=	RAL 9002 (grey white)

Example

Grounding		Arm version		Fixing		01 & 02 Colour
A	-	D908G	-	4S	.	CD
A	-	D908G	-	4S	.	gr1

General notes

Components' grounding

All arms with integrated cable management are equipped with **component grounding**. No grounding is required for arms with external or semi-integrated cable management with cables not being led through joints.

Load capacity

All **height adjustable arms** have a load capacity of 22 kg / 48.5 lbs. Rear mounted monitor adaptations and horizontally mounted 5" plunge plates accept a maximum monitor weight of 18 kg / 39.7 lbs. An additional 4 kg / 8.8 lbs may be mounted on a down post underneath the front swivel part. Depending on material and tensile factor all weight indications have a 4-fold and/ or 6-fold safety factor according to IEC 60601-1 standards.

Custom-designed solutions and MRI applications

Please contact us for **custom-designed** solutions.

Product marking

All products which are classified as medical product risk class 1 are CE marked. As **medical product risk class 1** they are conform with the regulations (EU) 2017/745 (MDR) and IEC 60601-1. Other standards of the IEC 60601 series are not applicable to our products, regardless of their version.

MD A stand-alone product that is already classified as a medical product class 1 before being integrated into an overall medical device. The product is CE-marked. A declaration of conformity is available.

 Accessories or spare parts that have no independent function and are therefore not subject to the MDR. These products are not CE-marked. A declaration of conformity is not required.

Warranty

All CIM products have a 5-year warranty to be free of defects in material and functionality from the date of delivery.